



Ref. 40364

**Plot of land in established part of Son Vida, walking distance of the hotel**

**Son Vida, Palma**

**Price: € 800.000**

Living area: m<sup>2</sup>  
Plot: 2.150m<sup>2</sup>  
Bedrooms: 1  
Bathrooms: 1

Energy Certificate: In Progress

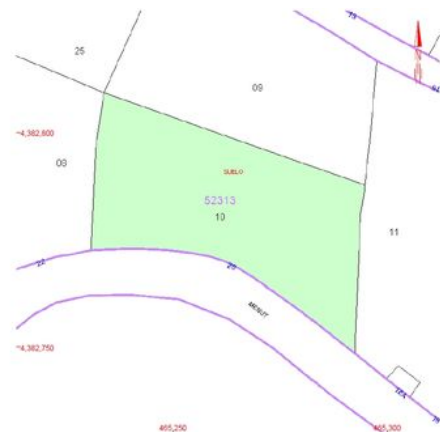

## Ref. 40364

South orientation.

Good building plot of 2,150 m2 overlooking the golf course Son Vida.

Buildable: 35%.

Son Vida is one of the most exclusive residential areas of Mallorca.

Near Palma, Son Vida offers 3 golf courses and two five-star hotels.

Very good and quick connections to Palma and the airport.

### Features

### Distances

10 - 20 minutes drive to airport, 10 - 20 minutes drive to Palma

### Disclaimer

All information provided here is deemed reliable but is not guaranteed and should be independently verified. No warranties or representations are made of any kind.

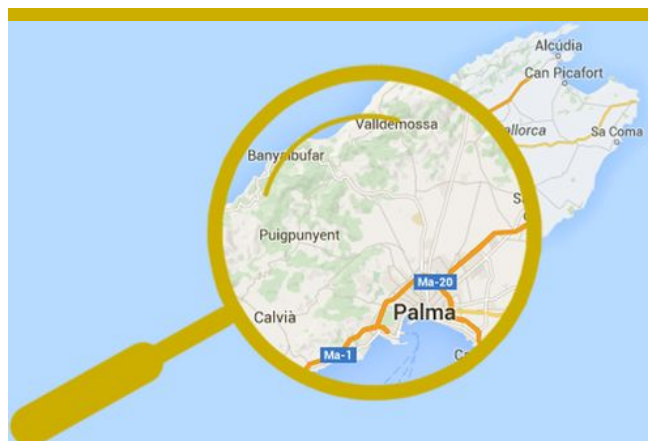
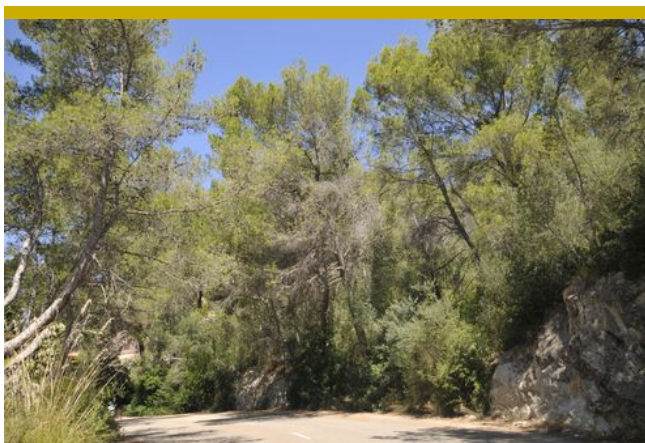

Ref. 40364